

TANDWIELEN MODUUL 1
TOOTH WHEELS MODULE 1
ZAHNRÄDER MODUL 1
ENGRENAGE MODULE 1

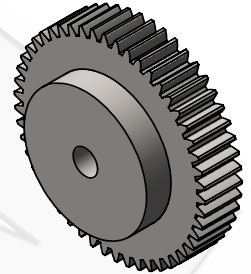

Recht gefreesd / drukhoek 20°
 Straight tooth / 20° transverse pressure angle

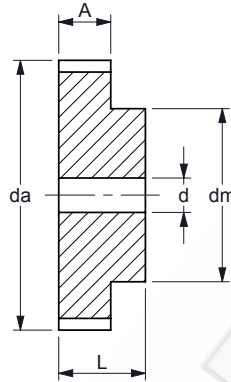
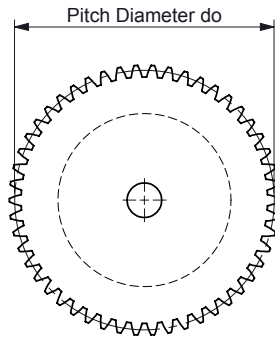

Tandbreedte / Tooth width A: 15 mm ---- Totale breedte / Total width L: 25 mm

K.T.N. Number	z	do [mm]	da [mm]	dm [mm]	d [mm]	q ca. [kg/pc]
40M010001200	12	12,0	14,0	9	5	0,01
40M010001300	13	13,0	15,0	10	5	0,02
40M010001400	14	14,0	16,0	10	5	0,02
40M010001500	15	15,0	17,0	12	6	0,02
40M010001600	16	16,0	18,0	13	6	0,03
40M010001700	17	17,0	19,0	14	8	0,03
40M010001800	18	18,0	20,0	15	8	0,03
40M010001900	19	19,0	21,0	15	8	0,04
40M010002000	20	20,0	22,0	16	8	0,04
40M010002100	21	21,0	23,0	16	8	0,05
40M010002200	22	22,0	24,0	18	8	0,05
40M010002300	23	23,0	25,0	18	8	0,06
40M010002400	24	24,0	26,0	20	8	0,06
40M010002500	25	25,0	27,0	20	8	0,07
40M010002600	26	26,0	28,0	20	8	0,07
40M010002700	27	27,0	29,0	20	8	0,08
40M010002800	28	28,0	30,0	20	8	0,08
40M010002900	29	29,0	31,0	20	8	0,09
40M010003000	30	30,0	32,0	20	8	0,09
40M010003100	31	31,0	33,0	25	10	0,11
40M010003200	32	32,0	34,0	25	10	0,12
40M010003300	33	33,0	35,0	25	10	0,12
40M010003400	34	34,0	36,0	25	10	0,13
40M010003500	35	35,0	37,0	25	10	0,14
40M010003600	36	36,0	38,0	25	10	0,14
40M010003700	37	37,0	39,0	25	10	0,15
40M010003800	38	38,0	40,0	25	10	0,16
40M010003900	39	39,0	41,0	25	10	0,16
40M010004000	40	40,0	42,0	25	10	0,17
40M010004100	41	41,0	43,0	30	10	0,19
40M010004200	42	42,0	44,0	30	10	0,20
40M010004300	43	43,0	45,0	30	10	0,21
40M010004400	44	44,0	46,0	30	10	0,22
40M010004500	45	45,0	47,0	30	10	0,23
40M010004600	46	46,0	48,0	30	10	0,23
40M010004700	47	47,0	49,0	30	10	0,24

K.T.N. Number	z	do [mm]	da [mm]	dm [mm]	d [mm]	q ca. [kg/pc]
40M010004800	48	48,0	50,0	30	10	0,25
40M010004900	49	49,0	51,0	30	10	0,26
40M010005000	50	50,0	52,0	30	12	0,26
40M010005100	51	51,0	53,0	40	12	0,32
40M010005200	52	52,0	54,0	40	12	0,33
40M010005300	53	53,0	55,0	40	12	0,33
40M010005400	54	54,0	56,0	40	12	0,34
40M010005500	55	55,0	57,0	40	12	0,36
40M010005600	56	56,0	58,0	40	12	0,37
40M010005700	57	57,0	59,0	40	12	0,38
40M010005800	58	58,0	60,0	40	12	0,39
40M010005900	59	59,0	61,0	40	12	0,40
40M010006000	60	60,0	62,0	40	12	0,41
40M010006100	61	61,0	63,0	50	12	0,47
40M010006200	62	62,0	64,0	50	12	0,49
40M010006300	63	63,0	65,0	50	12	0,50
40M010006400	64	64,0	66,0	50	12	0,51
40M010006500	65	65,0	67,0	50	12	0,52
40M010006600	66	66,0	68,0	50	12	0,53
40M010006700	67	67,0	69,0	50	12	0,55
40M010006800	68	68,0	70,0	50	12	0,56
40M010006900	69	69,0	71,0	50	12	0,57
40M010007000	70	70,0	72,0	50	12	0,58
40M010007200	72	72,0	74,0	-	12	0,46
40M010007500	75	75,0	77,0	-	12	0,51
40M010007600	76	76,0	78,0	-	12	0,52
40M010008000	80	80,0	82,0	-	12	0,58
40M010008500	85	85,0	87,0	-	12	0,65
40M010009000	90	90,0	92,0	-	12	0,73
40M010009500	95	95,0	97,0	-	12	0,82
40M010010000	100	100,0	102,0	-	12	0,91
40M010011000	110	110,0	112,0	-	12	1,10
40M010011400	114	114,0	116,0	-	12	1,19
40M010012000	120	120,0	122,0	-	12	1,32
40M010012700	127	127,0	129,0	-	12	1,47

Ook leverbaar in klantspecifieke uitvoering
 Also available with customized applications

TANDWIELEN MODUUL 1,5
TOOTH WHEELS MODULE 1,5
ZAHNRÄDER MODUL 1,5
ENGRENAGE MODULE 1,5

Recht gefreesd / drukhoek 20°
 Straight tooth / 20° transverse pressure angle

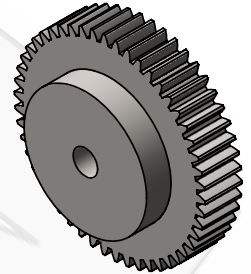
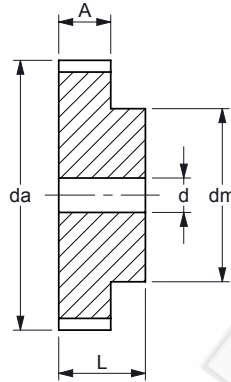
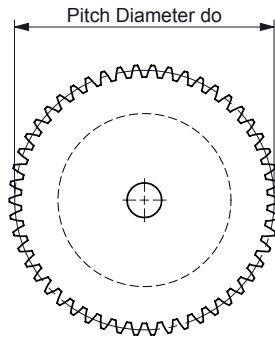

Tandbreedte / Tooth width A: 17 mm ---- Totale breedte / Total width L: 30 mm

K.T.N. Number	z	do [mm]	da [mm]	dm [mm]	d [mm]	q ca. [kg/pc]
40M015001200	12	18,0	21,0	14	8	0,04
40M015001300	13	19,5	22,5	14	8	0,05
40M015001400	14	21,0	24,0	17	8	0,06
40M015001500	15	22,5	25,5	18	8	0,07
40M015001600	16	24,0	27,0	20	8	0,08
40M015001700	17	25,5	28,5	20	8	0,09
40M015001800	18	27,0	30,0	20	8	0,10
40M015001900	19	28,5	31,5	20	8	0,10
40M015002000	20	30,0	33,0	25	8	0,13
40M015002100	21	31,5	34,5	25	10	0,13
40M015002200	22	33,0	36,0	25	10	0,14
40M015002300	23	34,5	37,5	25	10	0,16
40M015002400	24	36,0	39,0	25	10	0,17
40M015002500	25	37,5	40,5	25	10	0,18
40M015002600	26	39,0	42,0	30	12	0,20
40M015002700	27	40,5	43,5	30	12	0,22
40M015002800	28	42,0	45,0	30	12	0,23
40M015002900	29	43,5	46,5	30	12	0,24
40M015003000	30	45,0	48,0	30	12	0,26
40M015003100	31	46,5	49,5	35	12	0,30
40M015003200	32	48,0	51,0	35	12	0,31
40M015003300	33	49,5	52,5	35	12	0,33
40M015003400	34	51,0	54,0	35	12	0,34
40M015003500	35	52,5	55,5	35	12	0,36
40M015003600	36	54,0	57,0	35	12	0,37
40M015003700	37	55,5	58,5	40	12	0,42
40M015003800	38	57,0	60,0	40	12	0,44
40M015003900	39	58,5	61,5	40	12	0,46
40M015004000	40	60,0	63,0	40	12	0,48
40M015004100	41	61,5	64,5	50	14	0,50
40M015004200	42	63,0	66,0	50	14	0,59
40M015004300	43	64,5	67,5	50	14	0,61
40M015004400	44	66,0	69,0	50	14	0,63
40M015004500	45	67,5	70,5	50	14	0,65
40M015004600	46	69,0	72,0	50	14	0,66
40M015004700	47	70,5	73,5	50	14	0,70

K.T.N. Number	z	do [mm]	da [mm]	dm [mm]	d [mm]	q ca. [kg/pc]
40M015004800	48	72,0	75,0	50	14	0,70
40M015004900	49	73,5	76,5	50	14	0,73
40M015005000	50	75,0	78,0	50	14	0,76
40M015005100	51	76,5	79,5	60	15	0,86
40M015005200	52	78,0	81,0	60	15	0,89
40M015005300	53	79,5	82,5	60	15	0,91
40M015005400	54	81,0	84,0	60	15	0,94
40M015005500	55	82,5	85,5	60	15	0,96
40M015005600	56	84,0	87,0	60	15	0,98
40M015005700	57	85,5	88,5	60	15	1,00
40M015005800	58	87,0	90,0	60	15	1,03
40M015005900	59	88,5	91,5	60	15	1,06
40M015006000	60	90,0	93,0	60	15	1,09
40M015006100	61	91,5	94,5	70	20	1,22
40M015006200	62	93,0	96,0	70	20	1,25
40M015006300	63	94,5	97,5	70	20	1,28
40M015006400	64	96,0	99,0	70	20	1,31
40M015006500	65	97,5	100,5	70	20	1,34
40M015006600	66	99,0	102,0	70	20	1,37
40M015006700	67	100,5	103,5	70	20	1,40
40M015006800	68	102,0	105,0	70	20	1,43
40M015006900	69	103,5	106,5	70	20	1,46
40M015007000	70	105,0	108,0	70	20	1,50
40M015007200	72	108,0	111,0	-	20	1,19
40M015007500	75	112,5	115,5	-	20	1,30
40M015007600	76	114,0	117,0	-	20	1,33
40M015008000	80	120,0	123,0	-	20	1,48
40M015008500	85	127,5	130,5	-	20	1,67
40M015009000	90	135,0	138,0	-	20	1,88
40M015009500	95	142,5	145,5	-	20	2,09
40M015010000	100	150,0	153,0	-	20	2,32
40M015011000	110	165,0	168,0	-	20	2,82
40M015011400	114	171,0	174,0	-	20	3,03
40M015012000	120	180,0	183,0	-	20	3,36
40M015012700	127	190,5	193,5	-	20	3,77

Ook leverbaar in klantspecifieke uitvoering
 Also available with customized applications

TANDWIELEN MODUUL 2
TOOTH WHEELS MODULE 2
ZAHNRÄDER MODUL 2
ENGRENAGE MODULE 2



Recht gefreesd / drukhoek 20°
 Straight tooth / 20° transverse pressure angle

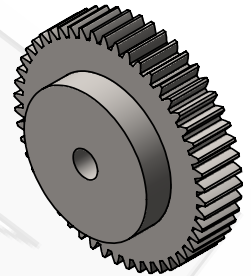
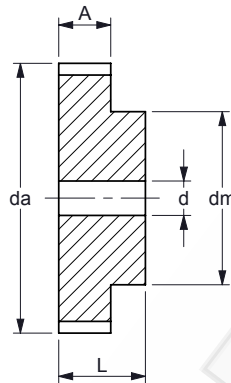
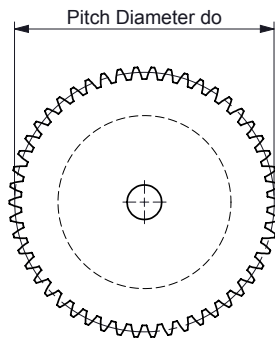

Tandbreedte / Tooth width A: 20 mm ---- Totale breedte / Total width L: 35 mm

K.T.N. Number	z	do [mm]	da [mm]	dm [mm]	d [mm]	q ca. [kg/pc]
40M020001200	12	24,0	28,0	18	10	0,08
40M020001300	13	26,0	30,0	19	10	0,10
40M020001400	14	28,0	32,0	20	10	0,12
40M020001500	15	30,0	34,0	22	10	0,14
40M020001600	16	32,0	36,0	24	10	0,16
40M020001700	17	34,0	38,0	25	10	0,18
40M020001800	18	36,0	40,0	25	10	0,19
40M020001900	19	38,0	42,0	25	10	0,21
40M020002000	20	40,0	44,0	30	10	0,26
40M020002100	21	42,0	46,0	30	12	0,27
40M020002200	22	44,0	48,0	30	12	0,29
40M020002300	23	46,0	50,0	30	12	0,31
40M020002400	24	48,0	52,0	35	12	0,36
40M020002500	25	50,0	54,0	35	12	0,39
40M020002600	26	52,0	56,0	40	12	0,45
40M020002700	27	54,0	58,0	40	12	0,47
40M020002800	28	56,0	60,0	40	12	0,50
40M020002900	29	58,0	62,0	40	14	0,52
40M020003000	30	60,0	64,0	40	14	0,55
40M020003100	31	62,0	66,0	45	14	0,61
40M020003200	32	64,0	68,0	45	14	0,65
40M020003300	33	66,0	70,0	45	14	0,68
40M020003400	34	68,0	72,0	45	14	0,71
40M020003500	35	70,0	74,0	45	14	0,74
40M020003600	36	72,0	76,0	45	14	0,78
40M020003700	37	74,0	78,0	50	14	0,86
40M020003800	38	76,0	80,0	50	14	0,90
40M020003900	39	78,0	82,0	50	14	0,93
40M020004000	40	80,0	84,0	50	14	0,97
40M020004100	41	82,0	86,0	60	16	1,05
40M020004200	42	84,0	88,0	60	16	1,09
40M020004300	43	86,0	90,0	60	16	1,13
40M020004400	44	88,0	92,0	60	16	1,23
40M020004500	45	90,0	94,0	60	16	1,27
40M020004600	46	92,0	96,0	60	16	1,31
40M020004700	47	94,0	98,0	60	16	1,48

K.T.N. Number	z	do [mm]	da [mm]	dm [mm]	d [mm]	q ca. [kg/pc]
40M020004800	48	96,0	100,0	70	16	1,53
40M020004900	49	98,0	102,0	70	16	1,57
40M020005000	50	100,0	104,0	70	16	1,62
40M020005100	51	102,0	106,0	70	20	1,67
40M020005200	52	104,0	108,0	70	20	1,72
40M020005300	53	106,0	110,0	70	20	1,78
40M020005400	54	108,0	112,0	70	20	1,83
40M020005500	55	110,0	114,0	70	20	1,88
40M020005600	56	112,0	116,0	70	20	1,94
40M020005700	57	114,0	118,0	70	20	1,99
40M020005800	58	116,0	120,0	70	20	2,05
40M020005900	59	118,0	122,0	70	20	2,11
40M020006000	60	120,0	124,0	70	20	2,16
40M020006100	61	122,0	126,0	80	20	2,36
40M020006200	62	124,0	128,0	80	20	2,42
40M020006300	63	126,0	130,0	80	20	2,48
40M020006400	64	128,0	132,0	80	20	2,55
40M020006500	65	130,0	134,0	80	20	2,61
40M020006600	66	132,0	136,0	80	20	2,67
40M020006700	67	134,0	138,0	80	20	2,74
40M020006800	68	136,0	140,0	80	20	2,81
40M020006900	69	138,0	142,0	80	20	2,87
40M020007000	70	140,0	144,0	-	20	2,94
40M020007200	72	144,0	148,0	-	20	2,50
40M020007500	75	150,0	154,0	-	20	2,71
40M020007600	76	152,0	156,0	-	20	2,79
40M020008000	80	160,0	164,0	-	20	3,09
40M020008500	85	170,0	174,0	-	20	3,50
40M020009000	90	180,0	184,0	-	20	3,93
40M020009500	95	190,0	194,0	-	20	4,39
40M020010000	100	200,0	204,0	-	20	4,87
40M020011000	110	220,0	224,0	-	20	5,90
40M020011400	114	228,0	232,0	-	20	6,34
40M020012000	120	240,0	244,0	-	20	7,03
40M020012700	127	254,0	258,0	-	20	7,89

Ook leverbaar in klantspecifieke uitvoering
 Also available with customized applications

TANDWIELEN MODUUL 2,5
TOOTH WHEELS MODULE 2,5
ZAHNRÄDER MODUL 2,5
ENGRENAGE MODULE 2,5

Recht gefreesd / drukhoek 20°
 Straight tooth / 20° transverse pressure angle

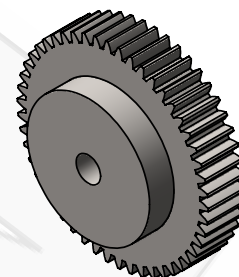
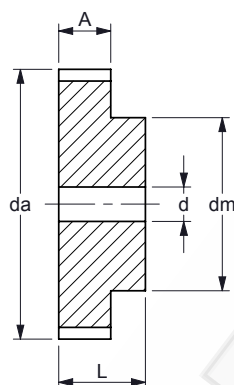
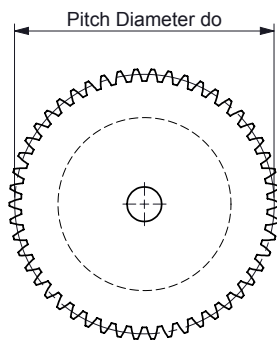

Tandbreedte / Tooth width A: 25 mm ---- Totale breedte / Total width L: 40 mm

K.T.N. Number	z	do [mm]	da [mm]	dm [mm]	d [mm]	q ca. [kg/pc]
40M025001200	12	30,0	35,0	22	10	0,15
40M025001300	13	32,5	37,5	25	10	0,19
40M025001400	14	35,0	40,0	28	10	0,23
40M025001500	15	37,5	42,5	30	10	0,30
40M025001600	16	40,0	45,0	32	12	0,30
40M025001700	17	42,5	47,5	35	12	0,34
40M025001800	18	45,0	50,0	35	12	0,38
40M025001900	19	47,5	52,5	35	12	0,40
40M025002000	20	50,0	55,0	40	14	0,48
40M025002100	21	52,5	57,5	40	14	0,52
40M025002200	22	55,0	60,0	45	14	0,59
40M025002300	23	57,5	62,5	45	14	0,64
40M025002400	24	60,0	65,0	45	14	0,68
40M025002500	25	62,5	67,5	50	14	0,75
40M025002600	26	65,0	70,0	50	14	0,82
40M025002700	27	67,5	72,5	50	14	0,87
40M025002800	28	70,0	75,0	50	14	0,91
40M025002900	29	72,5	77,5	50	14	1,00
40M025003000	30	75,0	80,0	55	16	1,07
40M025003100	31	77,5	82,5	55	16	1,14
40M025003200	32	80,0	85,0	55	16	1,20
40M025003300	33	82,5	87,5	55	16	1,20
40M025003400	34	85,0	90,0	55	16	1,32
40M025003500	35	87,5	92,5	60	16	1,42
40M025003600	36	90,0	95,0	60	16	1,47
40M025003700	37	92,5	97,5	60	16	1,57
40M025003800	38	95,0	100,0	60	16	1,65
40M025003900	39	97,5	102,5	60	16	1,72
40M025004000	40	100,0	105,0	70	20	1,92
40M025004100	41	102,5	107,5	70	20	2,00
40M025004200	42	105,0	110,0	70	20	2,08
40M025004300	43	107,5	112,5	70	20	2,16

K.T.N. Number	z	do [mm]	da [mm]	dm [mm]	d [mm]	q ca. [kg/pc]
40M025004400	44	110,0	115,0	70	20	2,23
40M025004500	45	112,5	117,5	70	20	2,25
40M025004600	46	115,0	120,0	70	20	2,36
40M025004700	47	117,5	122,5	80	20	2,53
40M025004800	48	120,0	125,0	80	20	2,69
40M025004900	49	122,5	127,5	80	20	2,77
40M025005000	50	125,0	130,0	80	20	2,86
40M025005100	51	127,5	132,5	90	20	3,20
40M025005200	52	130,0	135,0	90	20	3,23
40M025005300	53	132,5	137,5	90	20	3,33
40M025005400	54	135,0	140,0	90	20	3,41
40M025005500	55	137,5	142,5	90	20	3,52
40M025005600	56	140,0	145,0	100	20	3,82
40M025005700	57	142,5	147,5	100	20	3,94
40M025005800	58	145,0	150,0	100	20	4,04
40M025005900	59	147,5	152,5	100	20	4,13
40M025006000	60	150,0	155,0	100	20	4,25
40M025006500	65	162,5	167,5	-	20	4,01
40M025007000	70	175,0	180,0	-	20	4,60
40M025007200	72	180,0	185,0	-	20	4,90
40M025007500	75	187,5	192,5	-	20	5,40
40M025007600	76	190,0	195,0	-	20	5,50
40M025008000	80	200,0	205,0	-	25	6,10
40M025008500	85	212,5	217,5	-	25	6,77
40M025009000	90	225,0	230,0	-	25	7,45
40M025009500	95	237,5	242,5	-	25	8,60
40M025010000	100	250,0	255,0	-	25	9,43
40M025011000	110	275,0	280,0	-	25	11,37
40M025011400	114	285,0	290,0	-	25	12,14
40M025012000	120	300,0	305,0	-	25	13,54
40M025012700	127	317,5	322,5	-	25	15,50

Ook leverbaar in klantspecifieke uitvoering
 Also available with customized applications

TANDWIELEN MODUUL 3
TOOTH WHEELS MODULE 3
ZAHNRÄDER MODUL 3
ENGRENAGE MODULE 3

Recht gefreesd / drukhoek 20°
 Straight tooth / 20° transverse pressure angle

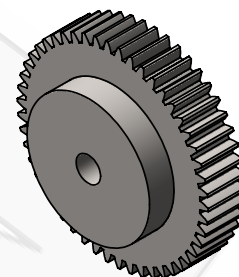
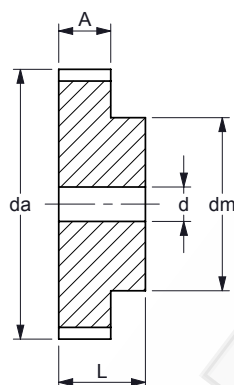
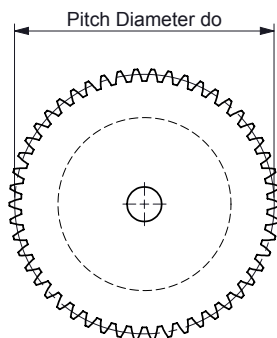

Tandbreedte / Tooth width A: 30 mm ---- Totale breedte / Total width L: 50 mm

K.T.N. Number	z	do [mm]	da [mm]	dm [mm]	d [mm]	q ca. [kg/pc]
40M030001200	12	36,0	42,0	25	12	0,28
40M030001300	13	39,0	45,0	25	12	0,34
40M030001400	14	42,0	48,0	30	12	0,41
40M030001500	15	45,0	51,0	35	12	0,47
40M030001600	16	48,0	54,0	38	15	0,54
40M030001700	17	51,0	57,0	42	15	0,63
40M030001800	18	54,0	60,0	45	15	0,72
40M030001900	19	57,0	63,0	45	15	0,78
40M030002000	20	60,0	66,0	45	15	0,84
40M030002100	21	63,0	69,0	45	15	0,89
40M030002200	22	66,0	72,0	50	15	1,02
40M030002300	23	69,0	75,0	50	15	1,10
40M030002400	24	72,0	78,0	50	16	1,18
40M030002500	25	75,0	81,0	60	16	1,39
40M030002600	26	78,0	84,0	60	16	1,48
40M030002700	27	81,0	87,0	60	16	1,56
40M030002800	28	84,0	90,0	60	16	1,66
40M030002900	29	87,0	93,0	60	16	1,75
40M030003000	30	90,0	96,0	60	16	1,85
40M030003100	31	93,0	99,0	70	20	1,95
40M030003200	32	96,0	102,0	70	20	2,21
40M030003300	33	99,0	105,0	70	20	2,32
40M030003400	34	102,0	108,0	70	20	2,43
40M030003500	35	105,0	111,0	70	20	2,55
40M030003600	36	108,0	114,0	70	20	2,62
40M030003700	37	111,0	117,0	80	20	2,74
40M030003800	38	114,0	120,0	80	20	3,05
40M030003900	39	117,0	123,0	80	20	3,18

K.T.N. Number	z	do [mm]	da [mm]	dm [mm]	d [mm]	q ca. [kg/pc]
40M030004000	40	120,0	126,0	80	20	3,31
40M030004100	41	123,0	129,0	90	20	3,44
40M030004200	42	126,0	132,0	90	20	3,58
40M030004300	43	129,0	135,0	90	20	3,72
40M030004400	44	132,0	138,0	90	20	4,07
40M030004500	45	135,0	141,0	90	20	4,22
40M030004600	46	138,0	144,0	90	20	4,37
40M030004700	47	141,0	147,0	90	20	4,76
40M030004800	48	144,0	150,0	100	20	4,92
40M030005000	50	150,0	156,0	-	25	4,06
40M030005200	52	156,0	162,0	-	25	4,40
40M030005500	55	165,0	171,0	-	25	4,93
40M030005700	57	171,0	177,0	-	25	5,30
40M030006000	60	180,0	186,0	-	25	5,89
40M030006500	65	195,0	201,0	-	25	6,92
40M030007000	70	210,0	216,0	-	25	8,00
40M030007200	72	216,0	222,0	-	25	8,47
40M030007500	75	225,0	231,0	-	25	9,21
40M030007600	76	228,0	234,0	-	25	9,46
40M030008000	80	240,0	246,0	-	25	10,49
40M030008500	85	255,0	261,0	-	25	11,86
40M030009000	90	270,0	276,0	-	25	13,32
40M030009500	95	285,0	291,0	-	25	14,86
40M030010000	100	300,0	306,0	-	25	16,48
40M030011000	110	330,0	336,0	-	25	19,97
40M030011400	114	342,0	348,0	-	30	21,40
40M030012000	120	360,0	366,0	-	30	23,74
40M030012700	127	381,0	387,0	-	30	26,61

Ook leverbaar in klantspecifieke uitvoering
 Also available with customized applications

TANDWIELEN MODUUL 4
TOOTH WHEELS MODULE 4
ZAHNRÄDER MODUL 4
ENGRENAGE MODULE 4

Recht gefreesd / drukhoek 20°
 Straight tooth / 20° transverse pressure angle

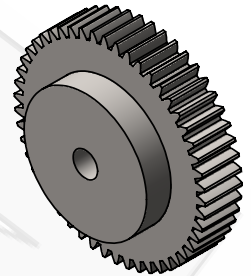
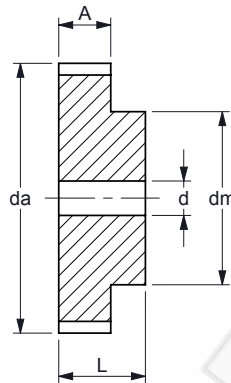
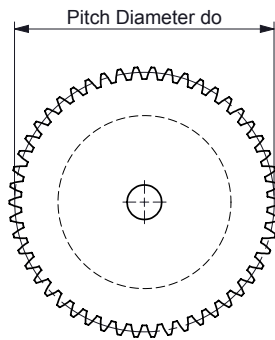

Tandbreedte / Tooth width A: 40 mm ---- Totale breedte / Total width L: 60 mm

K.T.N. Number	z	do [mm]	da [mm]	dm [mm]	d [mm]	q ca. [kg/pc]
40M040001200	12	48,0	56,0	35	14	0,63
40M040001300	13	52,0	60,0	40	14	0,78
40M040001400	14	56,0	64,0	45	14	0,93
40M040001500	15	60,0	68,0	45	14	1,05
40M040001600	16	64,0	72,0	50	15	1,20
40M040001700	17	68,0	76,0	50	15	1,33
40M040001800	18	72,0	80,0	50	15	1,47
40M040001900	19	76,0	84,0	60	15	1,75
40M040002000	20	80,0	88,0	60	15	1,90
40M040002100	21	84,0	92,0	70	20	2,22
40M040002200	22	88,0	96,0	70	20	2,39
40M040002300	23	92,0	100,0	75	20	2,60
40M040002400	24	96,0	104,0	75	20	2,79
40M040002500	25	100,0	108,0	75	20	2,98
40M040002600	26	104,0	112,0	75	20	3,18
40M040002700	27	108,0	116,0	75	20	3,39
40M040002800	28	112,0	120,0	75	20	3,60
40M040002900	29	116,0	124,0	75	20	3,83
40M040003000	30	120,0	128,0	75	20	4,06
40M040003100	31	124,0	132,0	80	20	4,39
40M040003200	32	128,0	136,0	80	20	4,64
40M040003300	33	132,0	140,0	80	20	4,90
40M040003400	34	136,0	144,0	80	20	5,16

K.T.N. Number	z	do [mm]	da [mm]	dm [mm]	d [mm]	q ca. [kg/pc]
40M040003500	35	140,0	148,0	80	20	5,43
40M040003600	36	144,0	152,0	80	20	5,63
40M040003800	38	152,0	160,0	-	25	5,20
40M040004000	40	160,0	168,0	-	25	6,11
40M040004500	45	180,0	188,0	-	25	7,78
40M040004800	48	192,0	200,0	-	25	8,87
40M040005000	50	200,0	208,0	-	25	9,65
40M040005200	52	208,0	216,0	-	25	10,45
40M040005500	55	220,0	228,0	-	25	11,71
40M040005700	57	228,0	236,0	-	25	12,59
40M040006000	60	240,0	248,0	-	25	13,97
40M040006500	65	260,0	268,0	-	25	16,43
40M040007000	70	280,0	288,0	-	25	19,09
40M040007500	75	300,0	308,0	-	25	21,94
40M040007600	76	304,0	312,0	-	25	22,47
40M040008000	80	320,0	328,0	-	25	24,93
40M040008500	85	340,0	348,0	-	25	28,18
40M040009000	90	360,0	368,0	-	25	31,62
40M040009500	95	380,0	388,0	-	25	35,26
40M040010000	100	400,0	408,0	-	25	39,11
40M040011000	110	440,0	448,0	-	25	47,38
40M040011400	114	456,0	464,0	-	25	50,91

Ook leverbaar in klantspecifieke uitvoering
 Also available with customized applications

TANDWIELEN MODUUL 5
TOOTH WHEELS MODULE 5
ZAHNRÄDER MODUL 5
ENGRENAGE MODULE 5

Recht gefreesd / drukhoek 20°
 Straight tooth / 20° transverse pressure angle

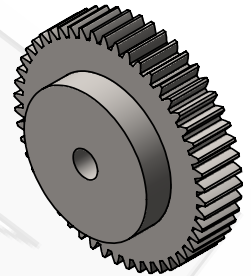
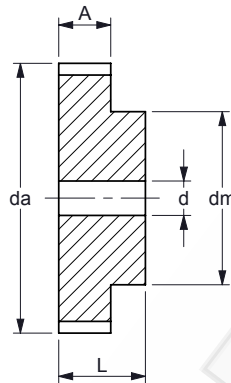
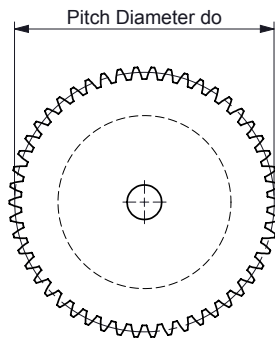

Tandbreedte / Tooth width A: 50 mm ---- Totale breedte / Total width L: 75 mm

K.T.N. Number	z	do [mm]	da [mm]	dm [mm]	d [mm]	q ca. [kg/pc]
40M050001200	12	60,0	70,0	45	16	1,21
40M050001300	13	65,0	75,0	50	16	1,47
40M050001400	14	70,0	80,0	55	20	1,76
40M050001500	15	75,0	85,0	60	20	2,07
40M050001600	16	80,0	90,0	65	20	2,40
40M050001700	17	85,0	95,0	70	20	2,75
40M050001800	18	90,0	100,0	70	20	3,02
40M050001900	19	95,0	105,0	70	20	3,30
40M050002000	20	100,0	110,0	80	20	3,83
40M050002100	21	105,0	115,0	80	20	4,15
40M050002200	22	110,0	120,0	80	25	4,48
40M050002300	23	115,0	125,0	90	25	5,08
40M050002400	24	120,0	130,0	90	25	5,44
40M050002500	25	125,0	135,0	90	25	5,82
40M050002600	26	130,0	140,0	100	25	6,50
40M050002700	27	135,0	145,0	100	25	6,91
40M050002800	28	140,0	150,0	100	25	7,22
40M050002900	29	145,0	155,0	100	25	7,98
40M050003000	30	150,0	160,0	100	25	8,44
40M050003200	32	160,0	170,0	-	25	7,62
40M050003500	35	175,0	185,0	-	25	9,16

K.T.N. Number	z	do [mm]	da [mm]	dm [mm]	d [mm]	q ca. [kg/pc]
40M050003800	38	190,0	200,0	-	30	10,84
40M050004000	40	200,0	210,0	-	30	12,04
40M050004500	45	225,0	235,0	-	30	15,30
40M050004800	48	240,0	250,0	-	30	17,44
40M050005000	50	250,0	260,0	-	30	18,86
40M050005200	52	260,0	270,0	-	30	20,43
40M050005500	55	275,0	285,0	-	30	22,89
40M050005700	57	285,0	295,0	-	30	24,62
40M050006000	60	300,0	310,0	-	30	27,31
40M050006500	65	325,0	335,0	-	30	32,12
40M050007000	70	350,0	360,0	-	30	37,31
40M050007500	75	375,0	385,0	-	30	42,88
40M050007600	76	380,0	390,0	-	30	44,04
40M050008000	80	400,0	410,0	-	30	48,84
40M050008500	85	425,0	435,0	-	30	55,19
40M050009000	90	450,0	460,0	-	30	61,92
40M050009500	95	475,0	485,0	-	30	69,03
40M050010000	100	500,0	510,0	-	30	76,53
40M050011000	110	550,0	560,0	-	30	92,69
40M050011400	114	570,0	580,0	-	30	99,59

Ook leverbaar in klantspecifieke uitvoering
 Also available with customized applications

TANDWIELEN MODUUL 6
TOOTH WHEELS MODULE 6
ZAHNRÄDER MODUL 6
ENGRENAGE MODULE 6

Recht gefreesd / drukhoek 20°
 Straight tooth / 20° transverse pressure angle

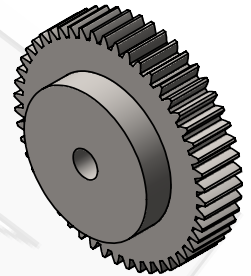
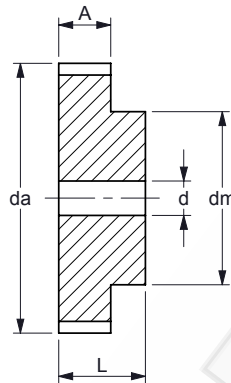
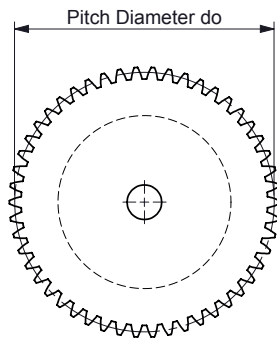

Tandbreedte / Tooth width A: 60 mm ---- Totale breedte / Total width L: 80 mm

K.T.N. Number	z	do [mm]	da [mm]	dm [mm]	d [mm]	q ca. [kg/pc]
40M060001200	12	72,0	84,0	54	20	1,82
40M060001300	13	78,0	90,0	60	20	2,20
40M060001400	14	84,0	96,0	65	20	1,60
40M060001500	15	90,0	102,0	70	20	3,01
40M060001600	16	96,0	108,0	75	20	3,46
40M060001800	18	108,0	120,0	80	20	4,33
40M060002000	20	120,0	132,0	90	20	5,43
40M060001800	23	138,0	150,0	110	25	8,00

K.T.N. Number	z	do [mm]	da [mm]	dm [mm]	d [mm]	q ca. [kg/pc]
40M060002400	24	144,0	156,0	110	25	7,88
40M060002500	25	150,0	162,0	110	25	8,42
40M060002800	28	168,0	180,0	-	25	8,41
40M060003000	30	180,0	192,0	-	25	9,69
40M060003200	32	192,0	204,0	-	25	11,05
40M060003500	35	210,0	222,0	-	25	13,27
40M060003800	38	228,0	240,0	-	25	15,69
40M060004000	40	240,0	252,0	-	25	17,42

Ook leverbaar in klantspecifieke uitvoering
 Also available with customized applications